



NEW SPEC LAB SUITES - AVAILABLE Q3 2024

SUITE 201 | 202 | 203 | 204

 SUITE 201  
±5,063 SF

 SUITE 202  
±5,886 SF

 SUITE 203  
±7,783 SF

 SUITE 204  
±6,445 SF

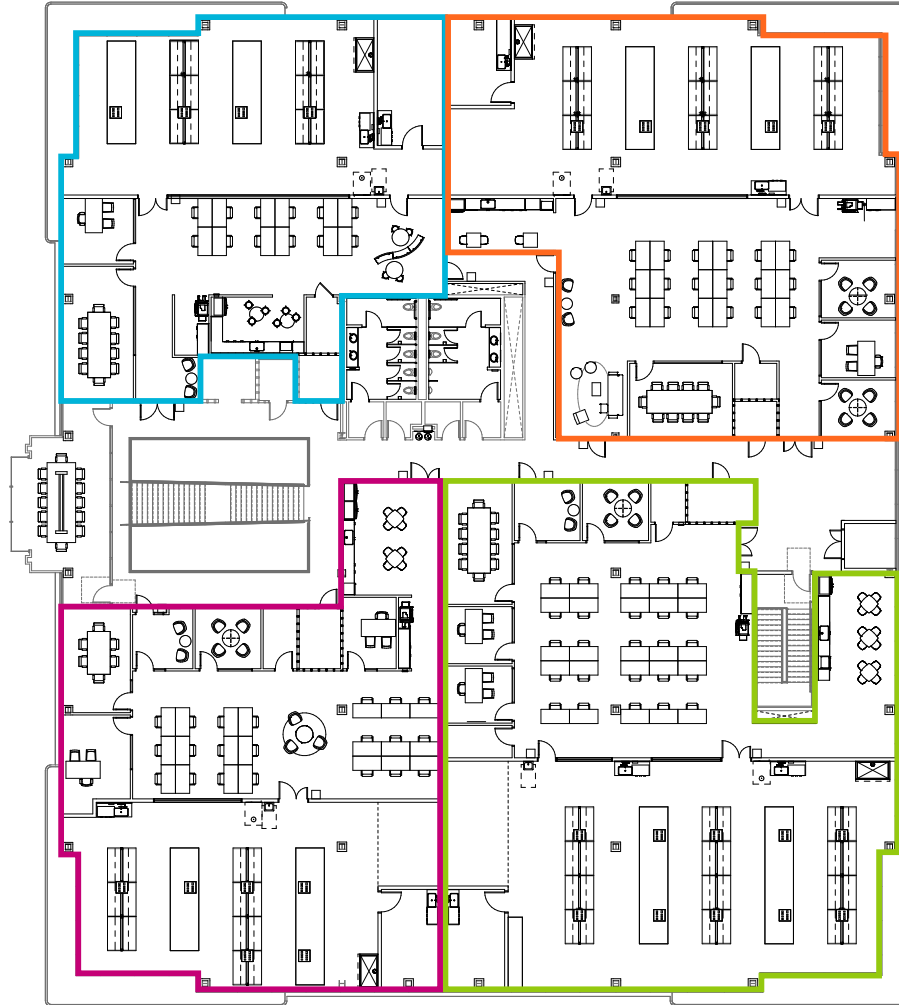

KEY PLAN



SITE PLAN

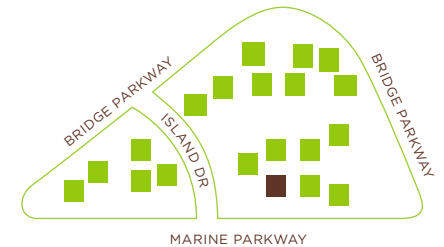

For more Information, please contact:

**BEN PAUL**  
+1 650 401 2123  
ben.paul@cushwake.com  
LIC #01210872

**MARC POPE**  
+1 650 401 2131  
marc.pope@cushwake.com  
LIC #01474483

**NICK WALDSMITH**  
+1 650 320 0244  
nick.waldsmith@cushwake.com  
LIC #02148008

