

NEW SPEC LAB SUITE - AVAILABLE Q3 2024

SUITE 101 - ±12,798 SF

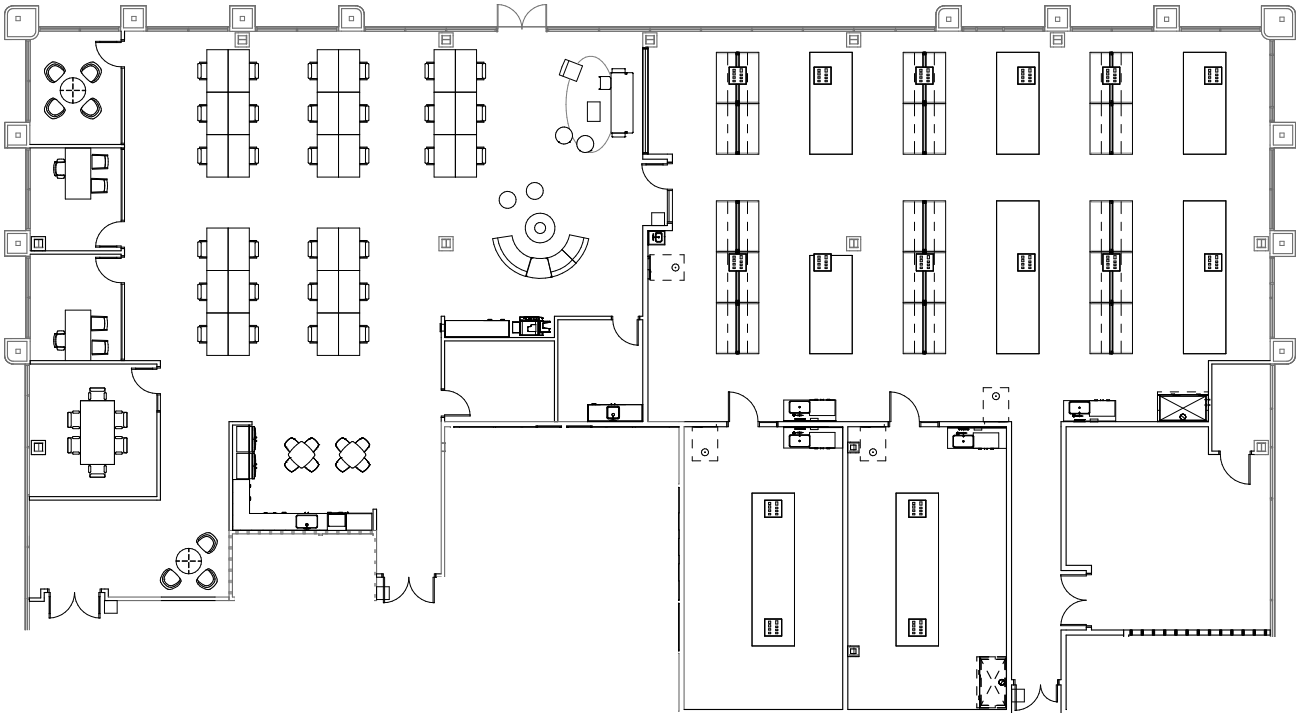

KEY PLAN

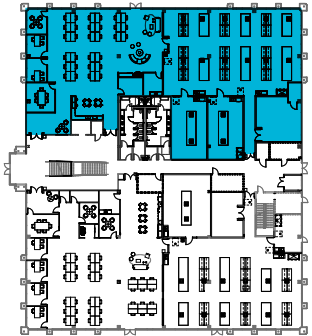

SITE PLAN

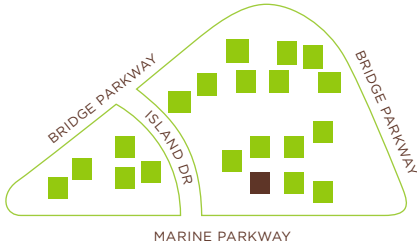

For more Information, please contact:

BEN PAUL
+1 650 401 2123
ben.paul@cushwake.com
LIC #01210872

MARC POPE
+1 650 401 2131
marc.pope@cushwake.com
LIC #01474483

NICK WALDSMITH
+1 650 320 0244
nick.waldsmith@cushwake.com
LIC #02148008

